

A diagram of a bar magnet. It is a horizontal rectangle with a grey shaded left half and a white right half. The grey half is labeled 'N' (North) and the white half is labeled 'S' (South). Above the grey half is a circle with a vertical line passing through its center, labeled 'N' at the top. Below the white half is a circle with a vertical line passing through its center, labeled 'S' at the bottom.

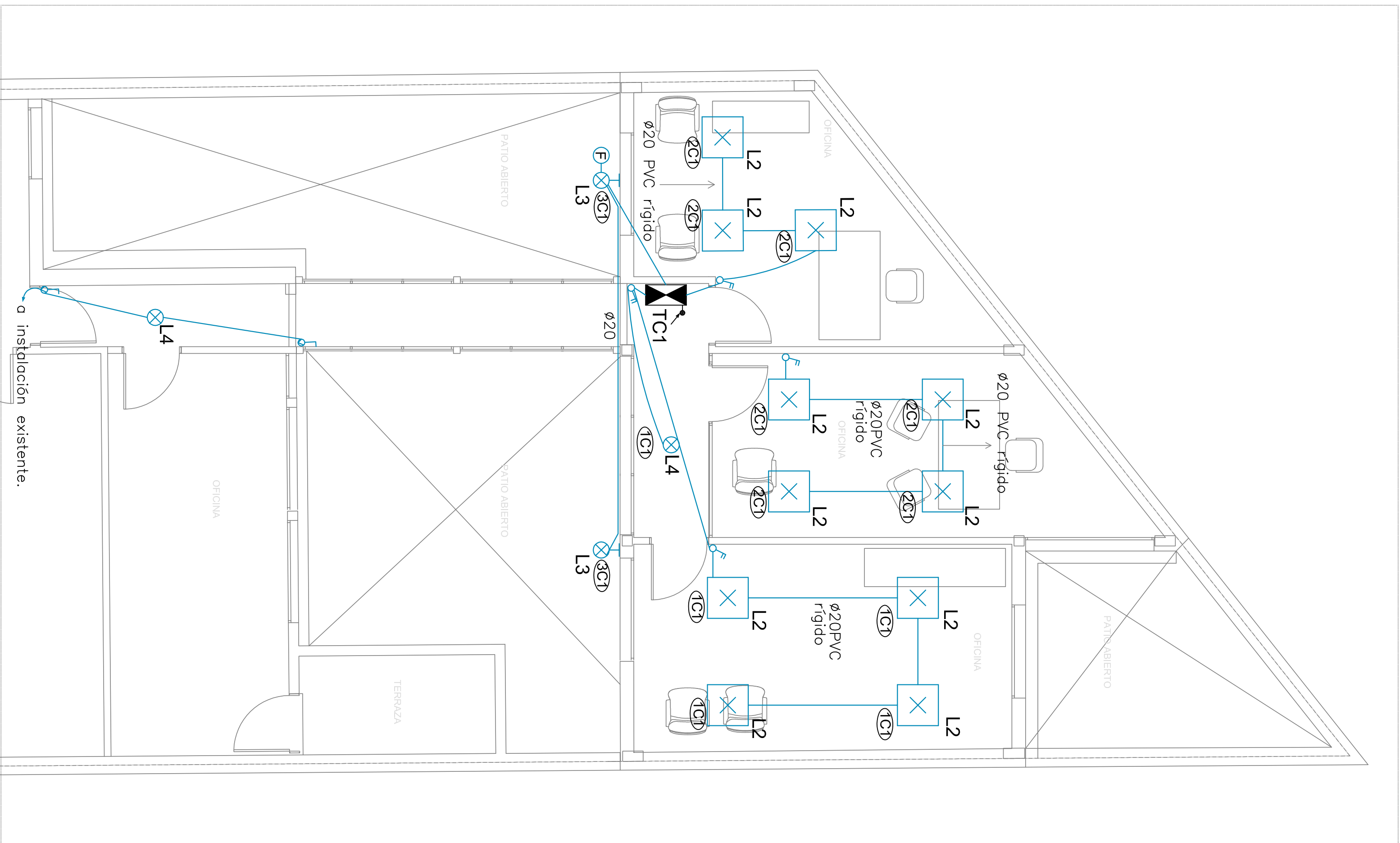

A diagram of a bar magnet. It is a horizontal rectangle with a grey shaded left half and a white right half. The grey half is labeled 'N' (North) and the white half is labeled 'S' (South). Above the grey half is a circle with a vertical line passing through its center, labeled 'N' at the top. Below the white half is a circle with a vertical line passing through its center, labeled 'S' at the bottom.

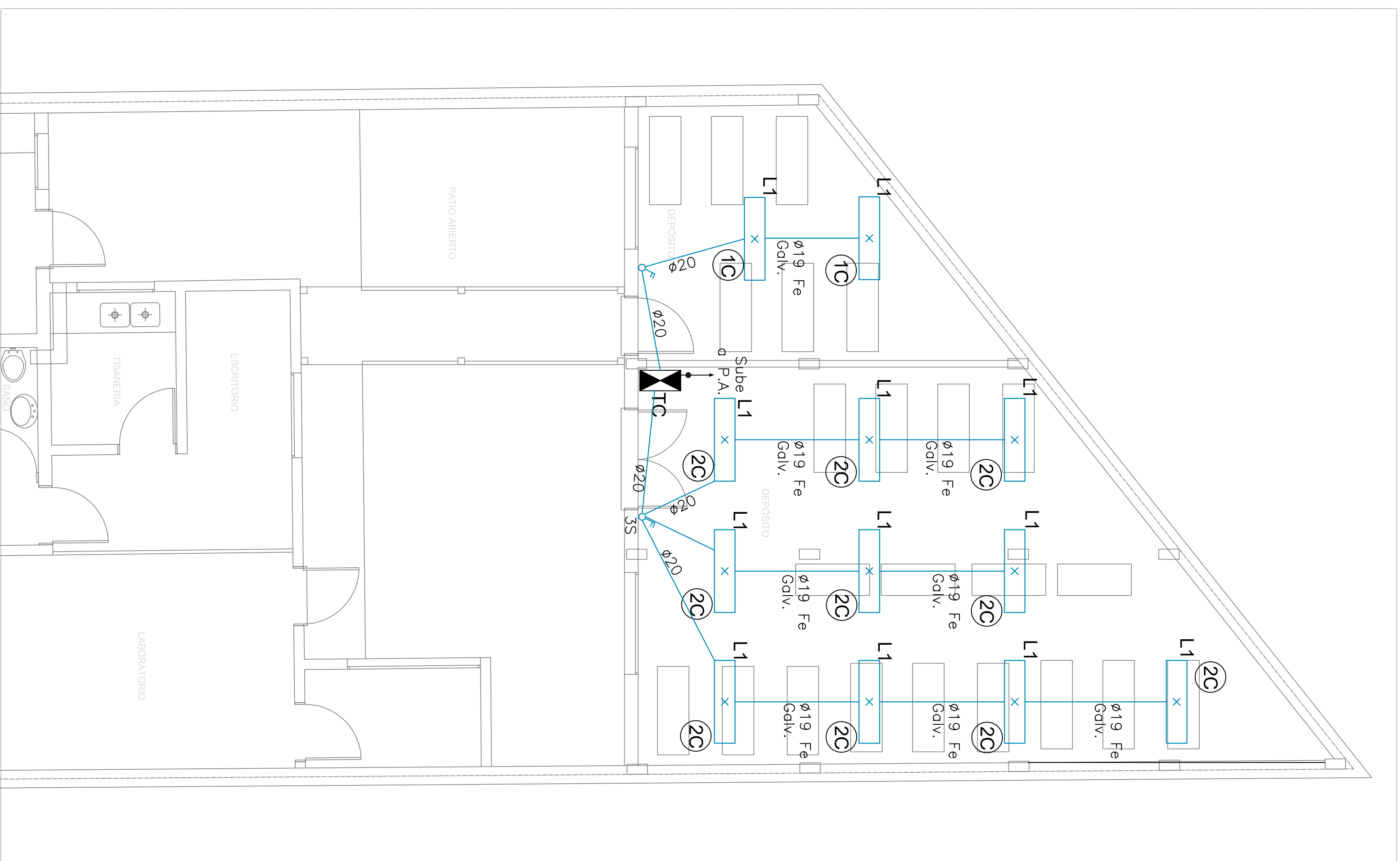

L1.- Luminaria de solera para 2x26W/código04. Marca Lumeneac modelo confort  
DP90 con equipo electrónico Marca Philips Profesional, Halexar Osram o equivalente.

L2.- Luminaria de embullir para 4x18W/código4. Marca Lucidote Modelo Clasic código  
R2D1-418 con equipo electrónico Marca Philips Profesional, Halexar, Osram o equivalente.

L3.- Luminaria tipo proyector para 3 lámparas F.L.C. D de 26W/código4. cuerpo en aluminio  
inoxidado, reflector de aluminio anodizado. Marca Lumeneac, Modelo Smart  
o equivalente.

L4.- Luminaria de embullir para una lámpara F.L.C.D de 26W/código4. Marca Lumeneac Modelo  
210 o equivalente.

L4- Luminária de embutir para uma lâmpara FLC-D de 26W/corlor84 Marca Lumenac Modelo 210 o equivalente.

[illegible]